



LP morgan

POP Screen user manual



Notes and Cautions



TIP: A tip indicates important information that helps you make better use of your screen.



WARNING: A notice indicates potential damage to ceiling and tells you how to avoid the problem.



DANGER: A caution indicates a potential for property damage, personal injury or death.

Table of contents



Important information

Unpacking 3



Installation

Installation - Top Grip Kit 4

Installation - Side Grip Kit 5

Installation - Stabilising Bars 6

Installation - Framed Screens 7



Appendix

Maintenance & Troubleshooting 10

Warranty Information 11

To the owner

Congratulations on purchasing an **LP Morgan** Pop Screen. A high quality, rigid and low cost rear projection screen, designed for visual merchandising applications. Please take a moment to review this manual, it will ensure you many years of trouble-free service from your new POP Screen vertical mounting kit.

Information in this document is subject to change without notice.

© 2002-2006 Herma Technologies. All rights reserved.

Reproduction in any manner whatsoever without permission of Herma Technologies is strictly forbidden. Trademarks used in this text: Herma, the Herma Logo, **LP Morgan** and **LP Morgan** logo are registered trademarks of Herma Technologies.

Other trademarks and trade names may be used in this document to refer to either the entities claiming the marks and names or their product. Herma Technologies disclaims interest in trademarks and trade names other than its own.

Unpacking the Pop Screen

Important information 

Supplied

Depending on the size of the screen chosen and the configuration you have chosen to mount your screen, you should have a selection of the components shown below:

2 x 2m Cable with top grip suspension kit

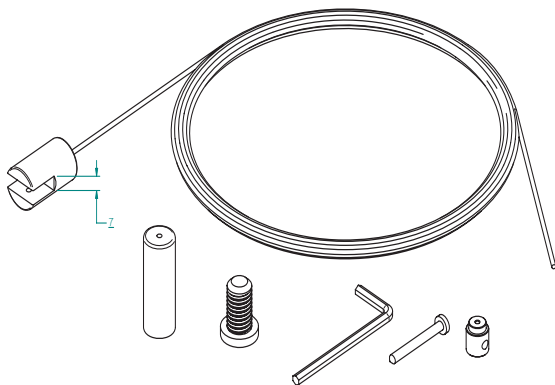

2 x 2m Cable with side grip suspension kit

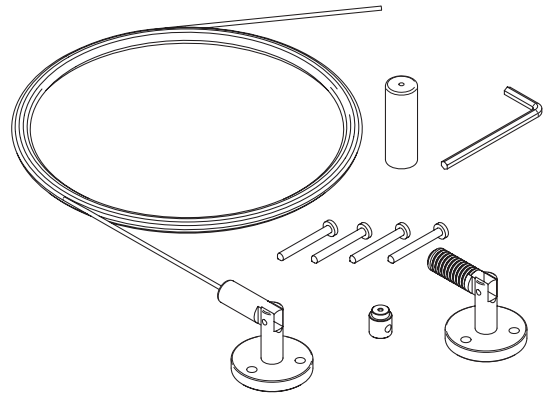

Stabilising bar kit (for 45", 49", 60" & 69" size screens only):

- 2 x Stabilising Bars
- 10 x Screen Grips
- 2 x Sliding mounts

misc:

- 1 x POP screen cut to size

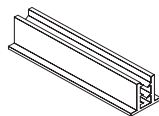
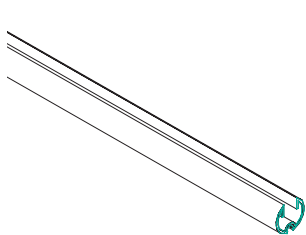

4 x End Caps



2 x M4x12 Grub Screws

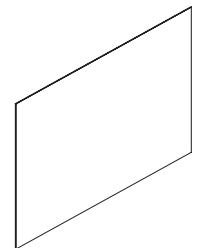

Frame Kits (NB: frame is pre-assembled if size is either 77" or 84")

4 x Pieces of frame extrusion

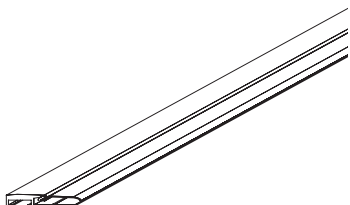

4 x corner bracket plate



4 x corner bracket

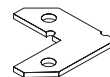

8 x M6 grub screws



M6 x 12 bolts



2 x frame tabs



2 x slide nuts

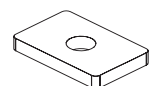

Installation: Top Grip Kit

Fig 1: Top Grip Assembly

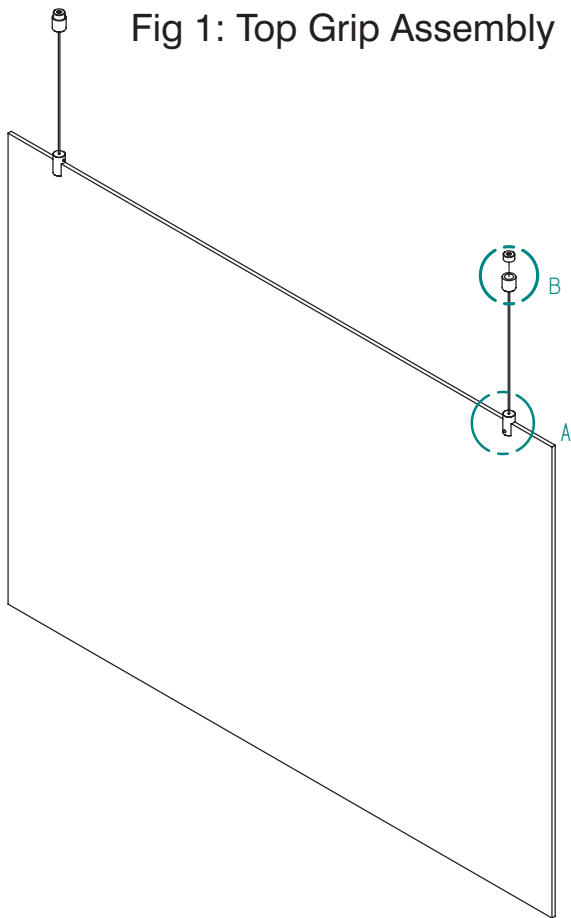

Mechanical
Installation



1. Position universal grips to POP Screen
(See fig 1. and Detail-A)
2. A-1 to secure wire; then A-2 to secure screen.
3. Screw top boss to ceiling
(See Fig 2, Detail-B) Determine desired screen height, trim wire to length.
(Default wire length = 2000mm).
4. Secure wire at the top with grub screw B-1

Detail B

Top
Boss

Fig 2:

Top Grip Hanging
Kit detail Assembly

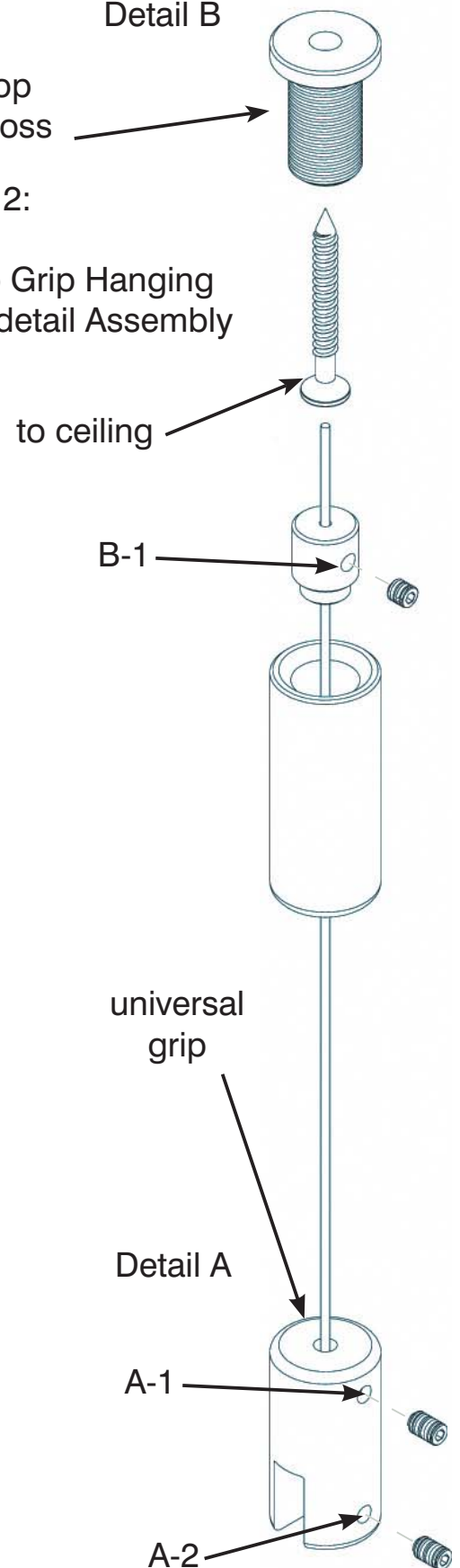

universal
grip

Detail A

A-1

A-2

Installation: Side Grip Kit

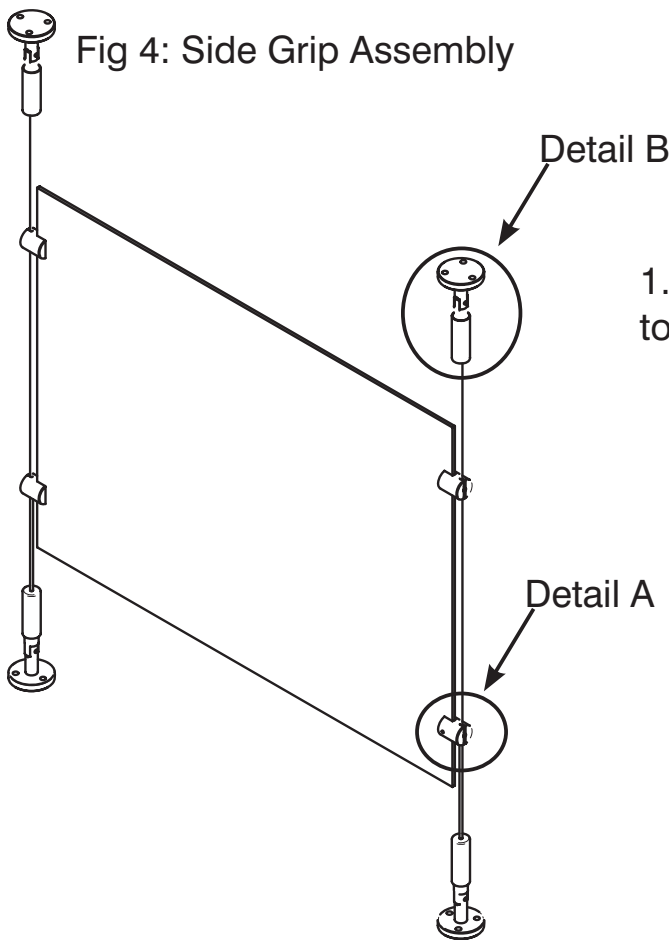

Fig. 4a:
(Detail A)

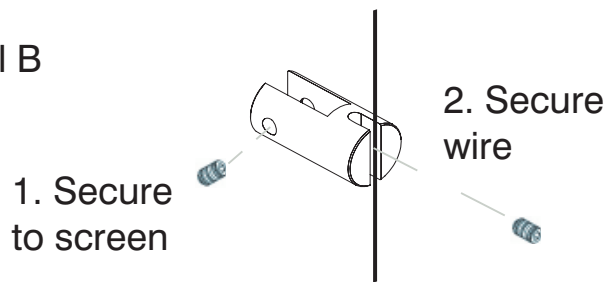
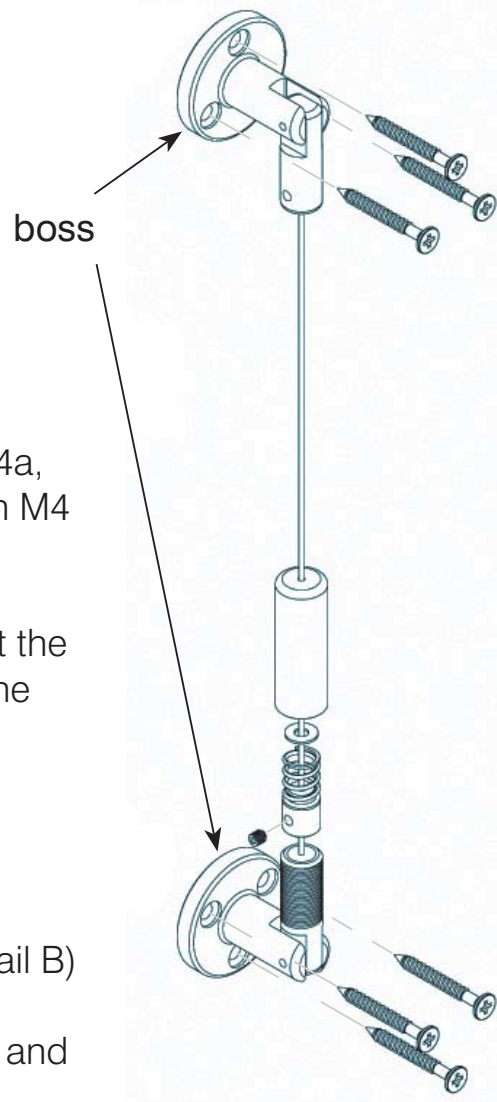

Fig 5: Side Grip Hanging Kit Assembly detail (Detail B)



1. Attach universal grip to POP Screen (See Fig 4a, step 1) using 2mm allen key (supplied) to tighten M4 grub screw.
2. Screw bosses to ceiling (or wall) - See Fig 5 at the appropriate spacing (depending on the size of the screen).
3. Determine desired cable length and trim appropriately.
4. Screw bottom boss to floor (or wall) (See Detail B)
5. Attach side grips to cable (see Fig. 4a step 2) and secure screen at the desired height.

Installation: Stabilising Bars

1. Remove plastic caps on both ends of top and bottom stabilising bars and remove clear plastic slide out screen grips (see fig. 6a)
2. Attach plastic grips to top and bottom edges of POP Screen. Make sure they are securely fastened. Slide in plastic slider into top stabilising bar.
3. Slide in screen with screen grip attached into channel of top and bottom stabilising bars. Replace
4. Secure Top Bosses (See fig 2 - Detail B) to ceiling at the appropriate spacing (this depends on the size of the screen).
5. Determine desired cable length and trim appropriately.
6. Secure universal grip to top stabilising bar (see fig. 6b).

Mechanical
Installation



Fig 6a: Stabilising Bar Assembly Detail

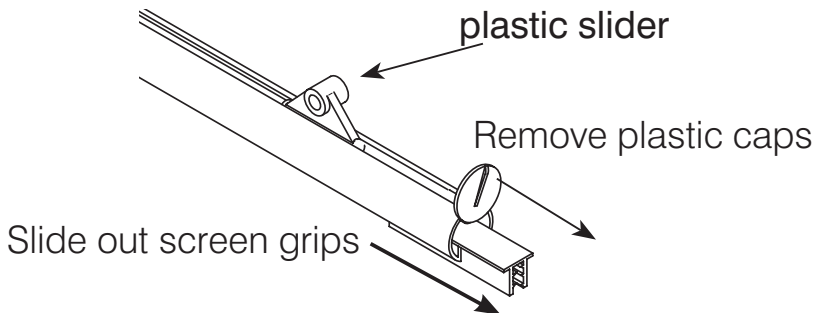

Fig 6b: Universal grip attachment detail

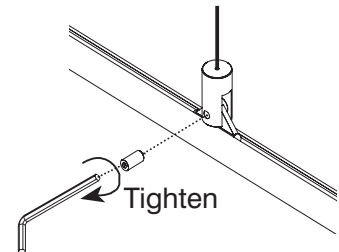
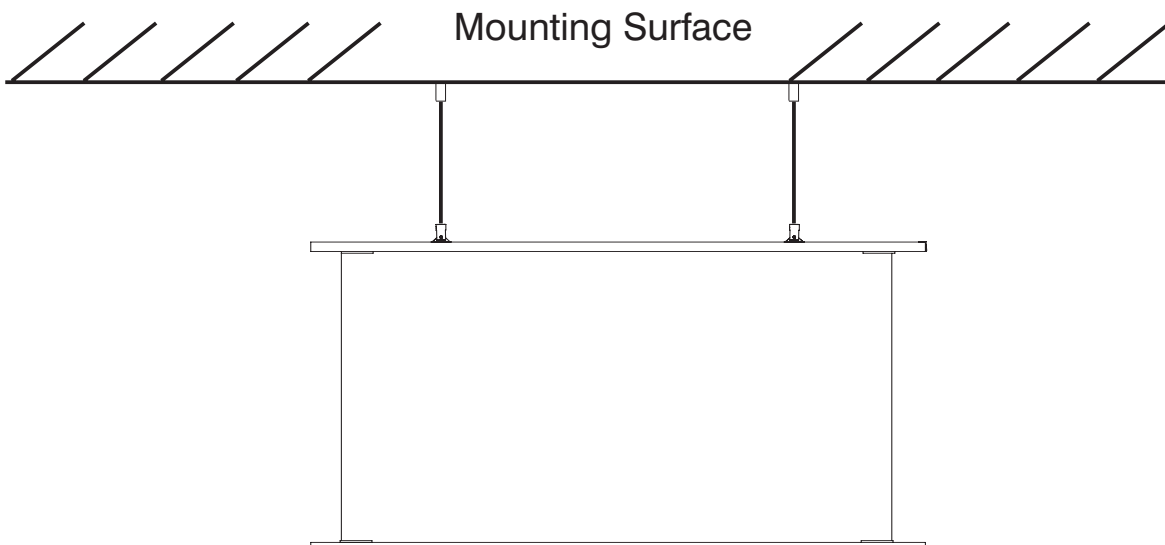

Fig 7: Assembled POP Screen with Stabilising Bars



Installation: Framed Screens

Frame Assembly:

- Note: If your screen has been pre-assembled, proceed to page 9.

1. Place two slide nuts into channel of frame section which is intended to be directly above top edge of image.
2. With frame pieces overturned, place corner bracket on corner bracket plate and slide both into channel as far as possible as shown in fig. 8.
3. Tighten M6 grub screw using a flathead screwdriver.
4. Repeat for three other corners placing brackets and frame pieces in position as shown in fig. 9
5. Position and align frame sections, tighten remaining grub screws to secure the frame.

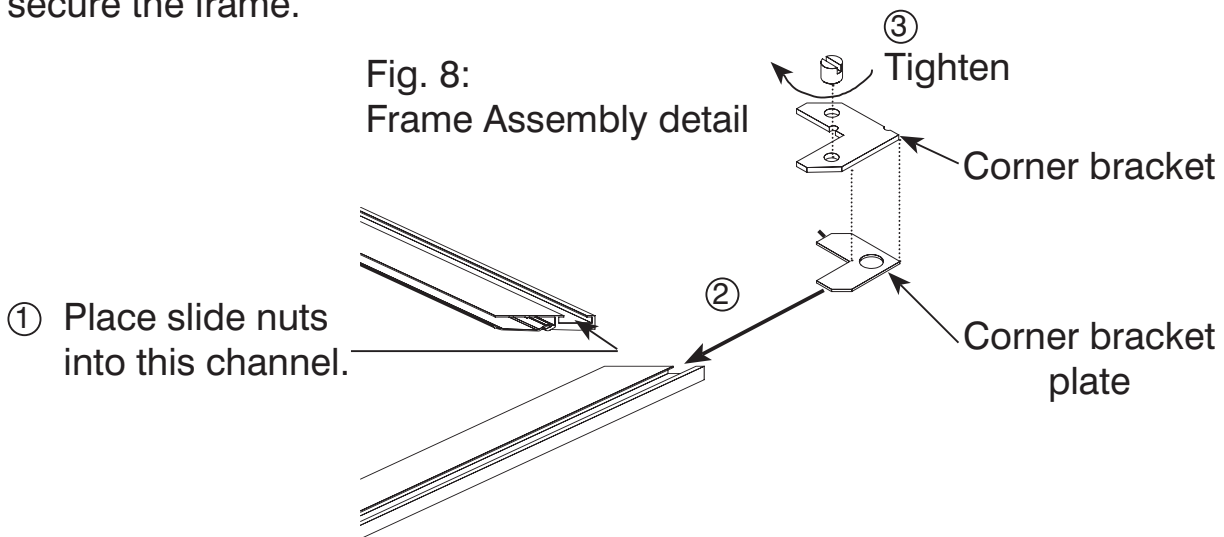
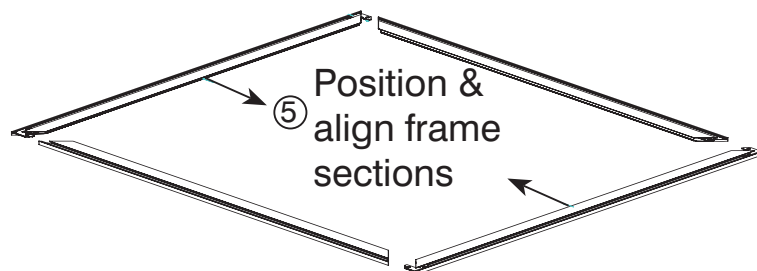

Fig. 9: Bracket fixturing for frame assembly.



Installation: Framed Screens

Screen Assembly:

1. Place the frame face up on a flat and stable surface.
2. Open the frame covers (located along the inner edge of the frame). To do this, reach inside of inner edge of frame and pull frame covers toward outer edge of frame.
3. Repeat for three other edges.
4. Place screen into the frame so that it is securely housed into the base of the frame.
5. Close all four opened frame covers over the frame.



Fig 10: Securing the screen into the frame

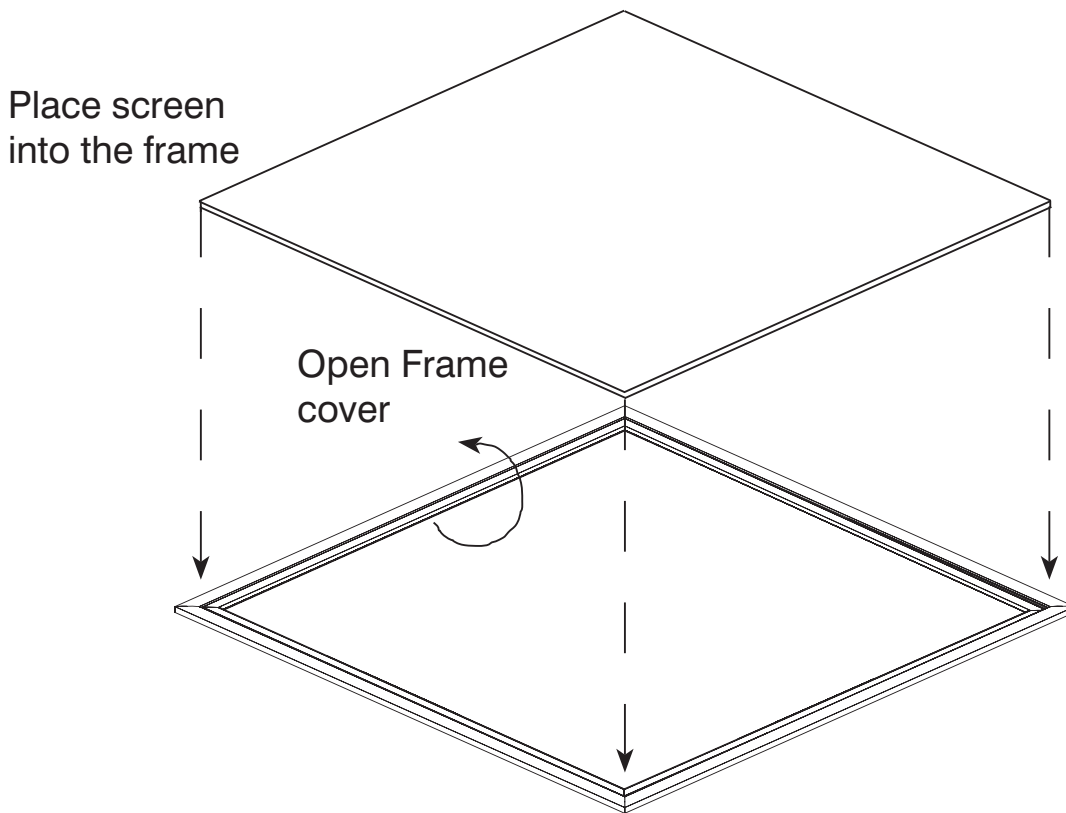

Installation: Framed Screens

Hanging Attachments and Configuration:

1. Determining appropriate spacing between hanging cables, secure top grip kits to ceiling. See page 4 of this instruction manual on details of how to do this.
2. Secure frame tabs to frame with M6 bolt passing through larger hole of frame tab to slide nut inside of frame channel.
3. Your framed POP screen should appear as that depicted in fig 12.

Fig 11: Hanging detail for framed screens.

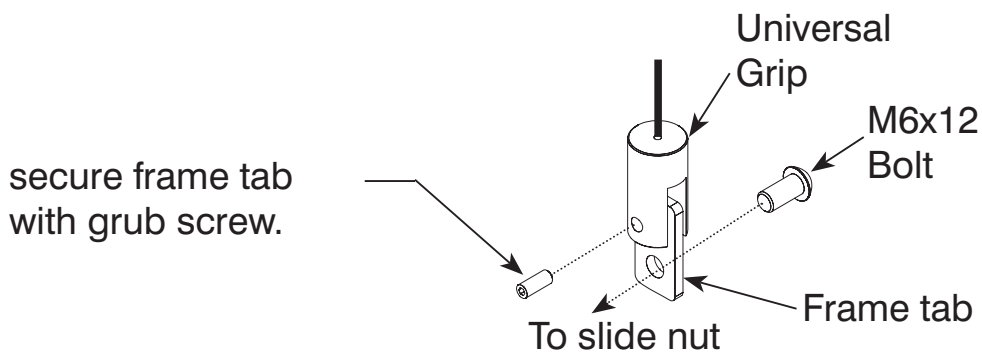
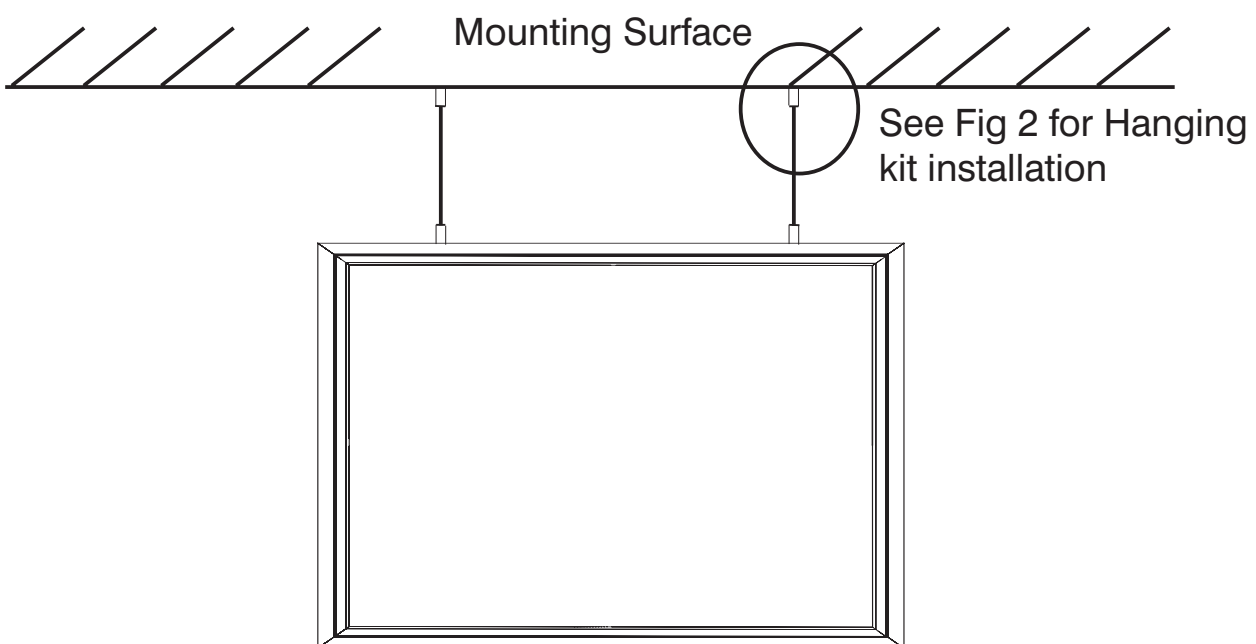

Fig 12 : Suspended Frame with Top Grip Suspension Kit



Maintenance and troubleshooting

Cleaning instructions:

The screen surface on your Pop Screen is extremely delicate. Special attention to these instructions should be followed when cleaning.

1. A draftsman's style brush may be used to lightly whisk away any loose dirt or dust particles. Do not use a sharp instrument to remove any particles. Softly brush from the centre to the edges.
2. The screen may be cleaned with a mild solution of detergent and water and a sponge or soft lint free cloth. Rub lightly to remove any stubborn marks, then blot with a damp sponge to absorb excess water. Use a clean sponge with clear water to wash off the detergent residue. Dry the screen with a soft cloth/towel so that the detergent does not have time to dry on the screen.
3. NEVER attempt to use solvents, chemicals or abrasive cleaners on the screen.
4. We encourage you to keep your screen clean. Avoid getting any foreign materials on it, as cleaning may prove to be very difficult or even impossible (scratches, paint, ink, etc.). Never paint in the vicinity of the screen unless the screen surface is completely protected.



With reasonable care you may expect years of trouble free use of your **LP Morgan POP** screen.

Warranty Information

Customers must fill out the online warranty form, or the warranty card included with the product and post it back to Herma at the reply paid address shown on the back cover in order to qualify for the manufacturer's warranty.

www.herma.com.au/warranty

The warranty covers defects in workmanship and materials, provided this product has been installed in a normal environment and maintained according to the written instructions. Herma warrants the product against loss of usefulness, discolouration or deterioration of optical quality within the warranty period as a result of manufacturing or material defects. This warranty applies only within Australia.

CONDITIONS –

Herma will repair or replace, with the least possible delay, any defective equipment. Any equipment replaced pursuant to the terms of this warranty shall be retained by Herma

All costs related to installation and re-installation of the Herma equipment covered by this warranty are not the responsibility of Herma Technologies. Herma will not be responsible for any consequential damages during or following installation procedures.

The user is responsible for any freight costs relating to repair or replacement. Equipment must be returned to Herma in suitable packing to prevent damage in transit. Herma will not accept any responsibility for damage to the equipment caused by inadequate or unsuitable packing, or for any damage howsoever caused whilst the goods are in transit.

Herma Technologies shall not be liable for any injury, loss or damage, direct or consequential, arising out of the use of, misuse of, or inability to use, the equipment.

This Warranty does not cover any equipment which has been subjected to misuse, abuse, neglect, accidental or intentional damage, improper voltage or any alteration which affects the reliability or performance of the equipment not attributable to faulty manufacture, parts or labour and without limiting the generality of the foregoing shall not apply where the defect arose as the result of the following circumstances:

This Warranty does not cover any equipment where usage, adaptation or installation (including wiring of electrical connections) are not in accordance with our written installation and operating instructions.

Warranty Period: 2 years



Your **LP Morgan** Retailer is able to provide information on your product. If we can be of any further help, please contact us.



Factory 4a, 6 Albert Street Preston Vic 3072

Phone: +61 3 9480 6233 Fax: +61 3 9480 6533

Email: info@herma.com.au

www.lpmorgan.com.au